

CORA BIKE RACK

PRODUCT SPECIFICATION SHEET

ASR-E eSCOOTER CHARGING RACK

- A stylish Adult Scooter Rack (ASR) that can charge 1x e-scooter while parked
- A sought after amenity for bike rooms - indoor use only
- User to supply appropriate charging cord which can be secured to the rack with a padlock
- Racks are individually lockable with the user's own U-Lock

SECURELY LOCK YOUR SCOOTER WHILE SAFELY CHARGING



ASR-E
(e-scooter charging rack)

ASR-E INSTALLATION WARNING:

The ASR-E rack requires the installation of electrical components and connection to a mains power source by a licensed electrical contractor in accordance with all relevant Australian regulations and specifications.

The ASR-E rack is for indoor installation only. ASR-E is not to be installed in locations where power points will be exposed to water ingress.

Speak to your qualified electrician about connecting multiple racks in one install.

DESIGNED FOR →



BATTERY
POWERED
MOTORS



USER SUPPLIED
POWER CORD

SPECIFICATIONS

Capacity	Finish	Fixings	Assembly	Construction	Function
1 scooter per rack	<ul style="list-style-type: none">- Cora ceramic or colour powder coat range- 304 stainless steel	3 x M10 x 80mm anchor bolts with tamper resistant fasteners	Qualified electrician to attach electric outlets and power supply Attach lock brackets and fix rack to concrete surface	Main post: 100x50x2mm pipe Lock bracket: 5mm steel	Accommodates most standard adult size scooters and e-scooters

CORA BIKE RACK

PRODUCT SPECIFICATION SHEET

ASRe - eSCOOTER CHARGING RACK LAYOUT GUIDE

SCOOTER RACK SPACING - 400mm minimum between scooters and 300mm minimum to a wall or other obstruction.

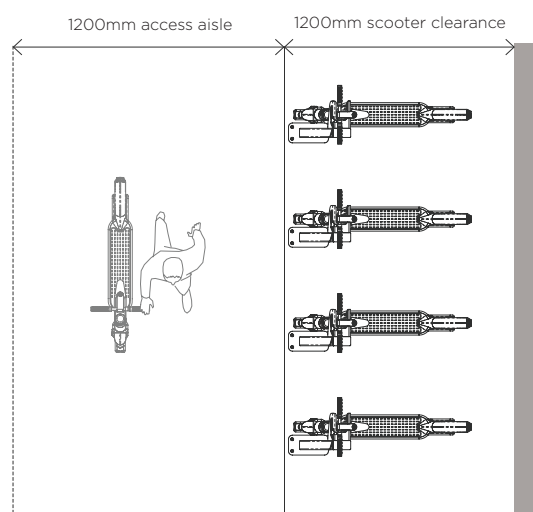

TOP VIEW

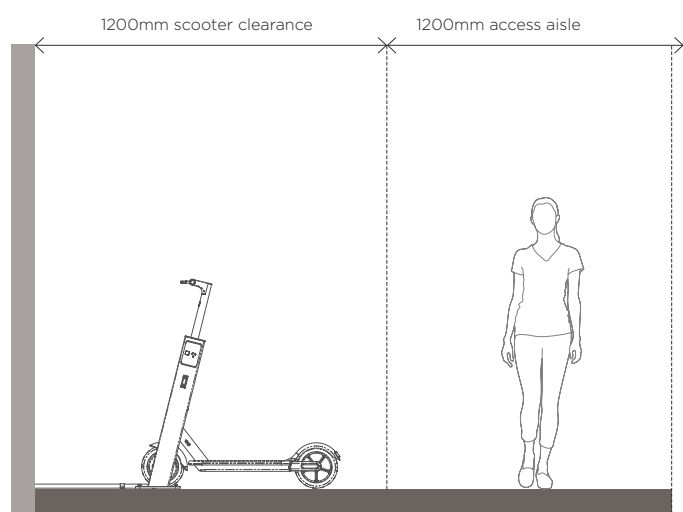

SIDE VIEW

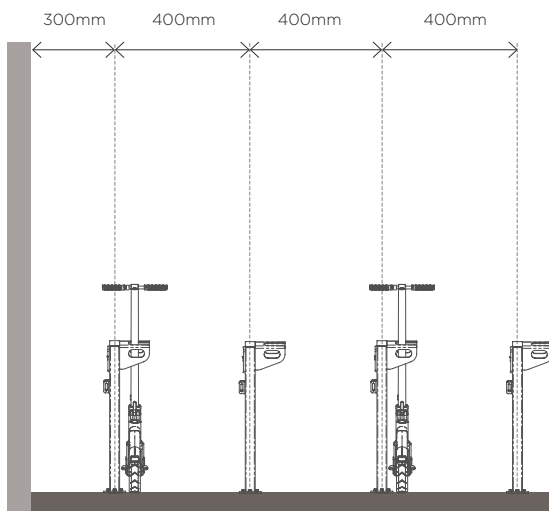

FRONT VIEW



PERSPECTIVE VIEW SHOWING ELECTRICAL CONDUIT

Refer to Installation Instructions sheet for specific installation and assembly guidelines. Racks should **NOT** be installed based on this sheet alone.

CORA BIKE RACK

PRODUCT SPECIFICATION SHEET

ASRe - eSCOOTER CHARGING RACK ELECTRICAL LAYOUT OPTIONS

ASR-e SHOULD ONLY BE INSTALLED BY A **LICENSED /CERTIFIED/QUALIFIED** ELECTRICAL CONTRACTOR

1 SINGLE RACK - WALL CONDUIT

- ▶ The ASR-e rack can be installed as a single rack
- ▶ Power cable routed directly into the side of ASR-e post (inside electrical conduit tube)
- ▶ The ASR-e post is designed to accept 20mm diameter electrical conduit tubing

Power cable routed into the side of the ASR-e post - attached securely to the floor inside electrical conduit tube

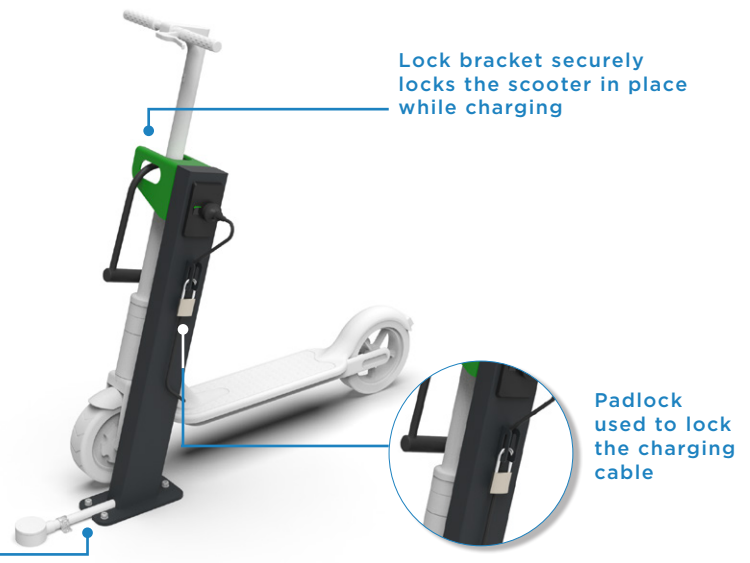

2 SINGLE RACK - GROUND CONDUIT

- ▶ Power cable can also be routed from a subsurface connection directly into the bottom of the rack post

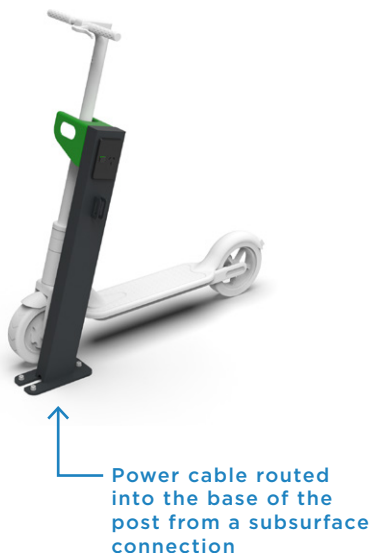

3 MULTI RACK - DAISY CHAIN CONDUIT

- ▶ Joining multiple racks using electrical conduit is possible. It is important the design is specified by a qualified electrician

